

Fill Your CuBe

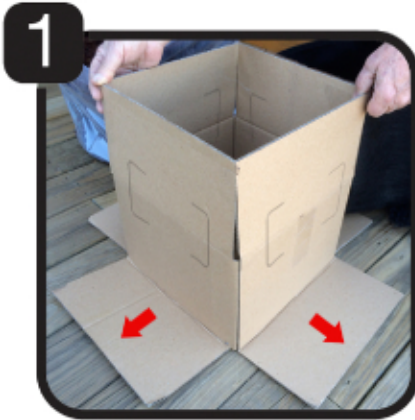

Open bottom of box with flaps out

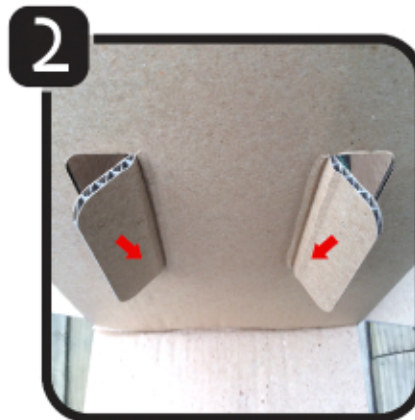

Push out both flaps on four sides of box



Place one DekProTek in bottom
Makes sure the box is square



Place one CuBe in box on top of DekProTek
Make sure bottom is smooth and square



Use hands or scoop to fill CuBe with EZ-Earth soil



Work soil into corners. Make sure corners and
sides are straight with no creases
Lightly firm the soil in place



Fill the CuBe 1-2 inches from the top.
Add 1 pack of fertilizer, work into top 3-4
inches of soil. Lightly compact the soil



Lift the box form off the CuBe
Now your ready to plant



To move the CuBe pinch one upper corner
and place other hand on the DekProTek and
CuBe and gently slide over the surface



Scan with smart phone or
tablet for instructional video*
*QR Code Reader Application needed

www.victory8garden.com